

Soils Map

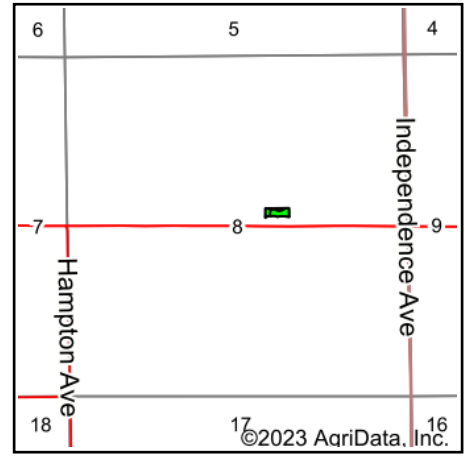

State: **Iowa**
 County: **Muscatine**
 Location: **8-76N-3W**
 Township: **Seventy-Six**
 Acres: **1.08**
 Date: **11/2/2023**

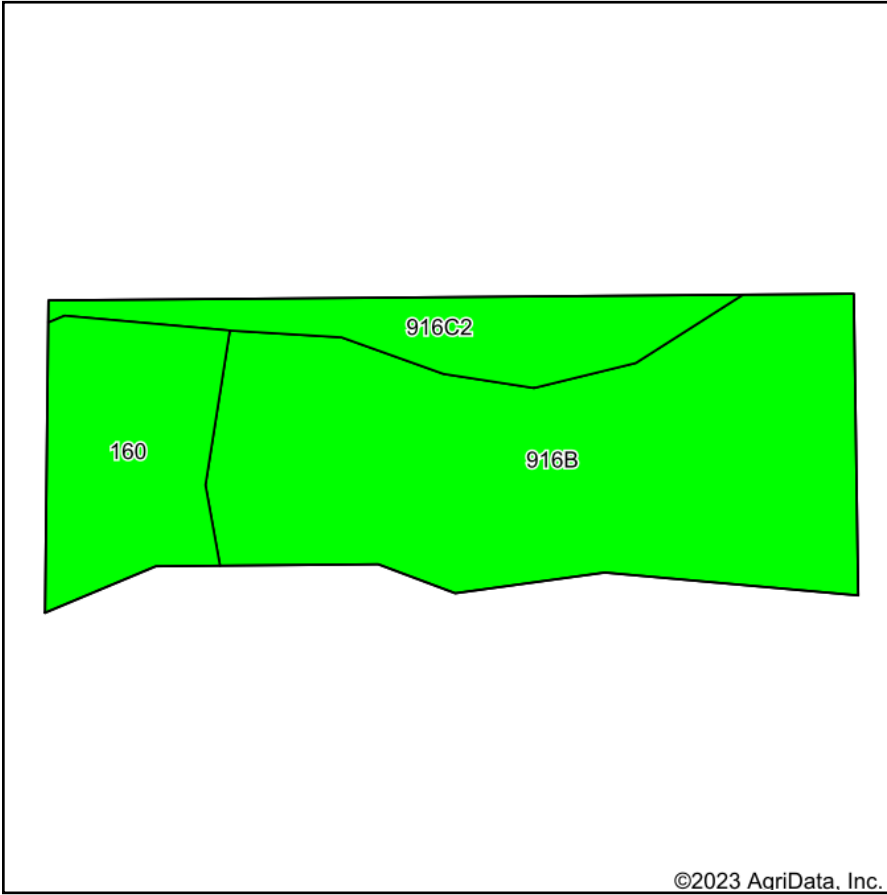

Maps Provided By:

 CUSTOMIZED ONLINE MAPPING
 © AgriData, Inc. 2023 www.AgriDataInc.com



Soils data provided by USDA and NRCS.

Area Symbol: IA139, Soil Area Version: 29								
Code	Soil Description	Acres	Percent of field	CSR2 Legend	Non-Irr Class *c	CSR2**	CSR	
916B	Downs silt loam, sandy substratum, 2 to 5 percent slopes	0.71	65.7%		Ile	88	77	
160	Walford silt loam, 0 to 2 percent slopes	0.21	19.4%		IIw	82	65	
916C2	Downs silt loam, sandy substratum, 5 to 9 percent slopes, eroded	0.16	14.8%		IIIe	80	62	
Weighted Average						2.15	85.6	72.4

**IA has updated the CSR values for each county to CSR2.
 *c: Using Capabilities Class Dominant Condition Aggregation Method
 Soils data provided by USDA and NRCS.